

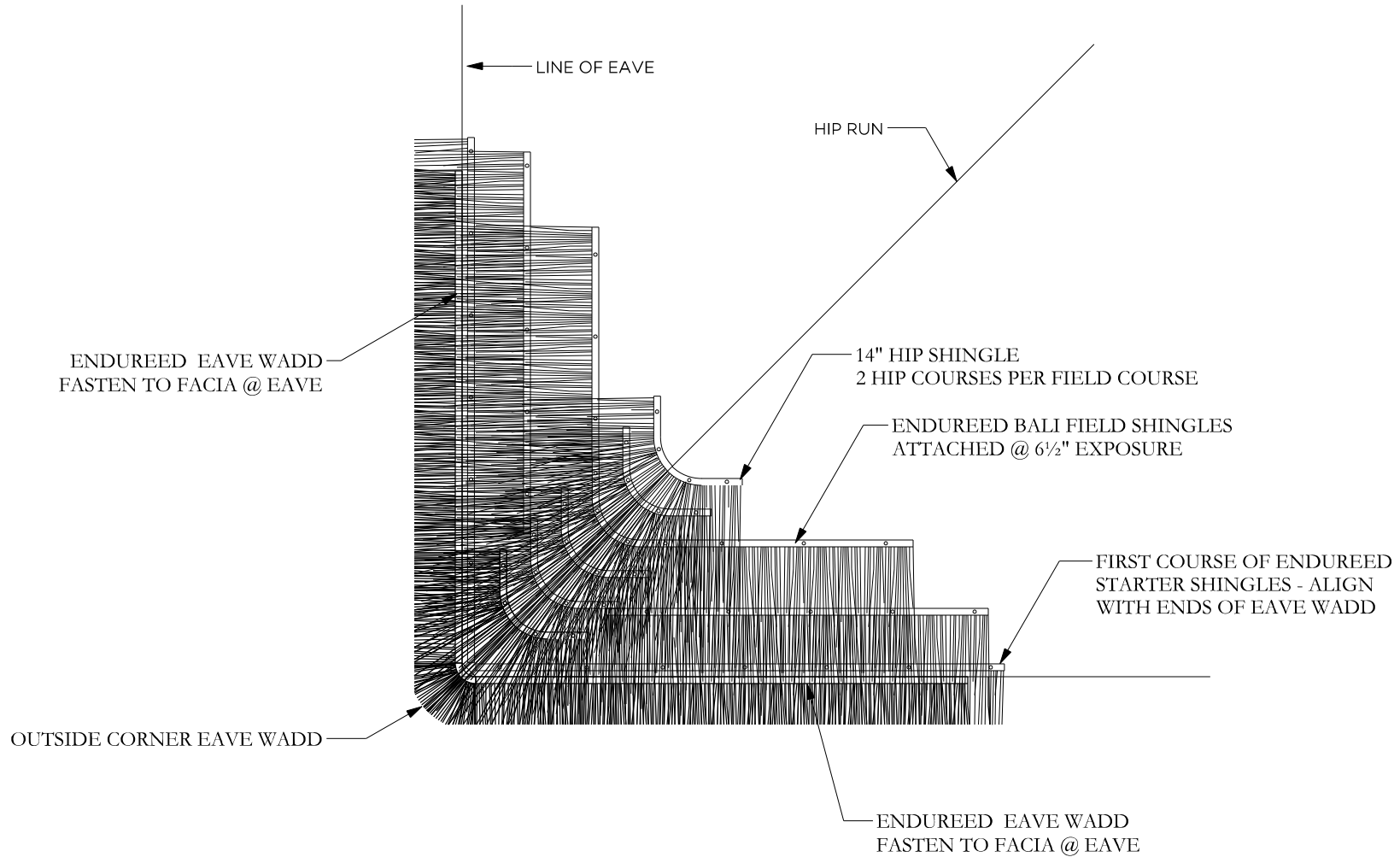

# Bali Trimmed Hip Detail



## TRIMMED EAVE HIP ATTACHMENT PLAN

SCALE: 1" = 1'-0"

Global Innovation  
 313 SW Windswept Glen  
 Lake City, FL 32024  
 1-877-784-2824 | [endureed.com](http://endureed.com)





# Bali Trimmed Eave Detail

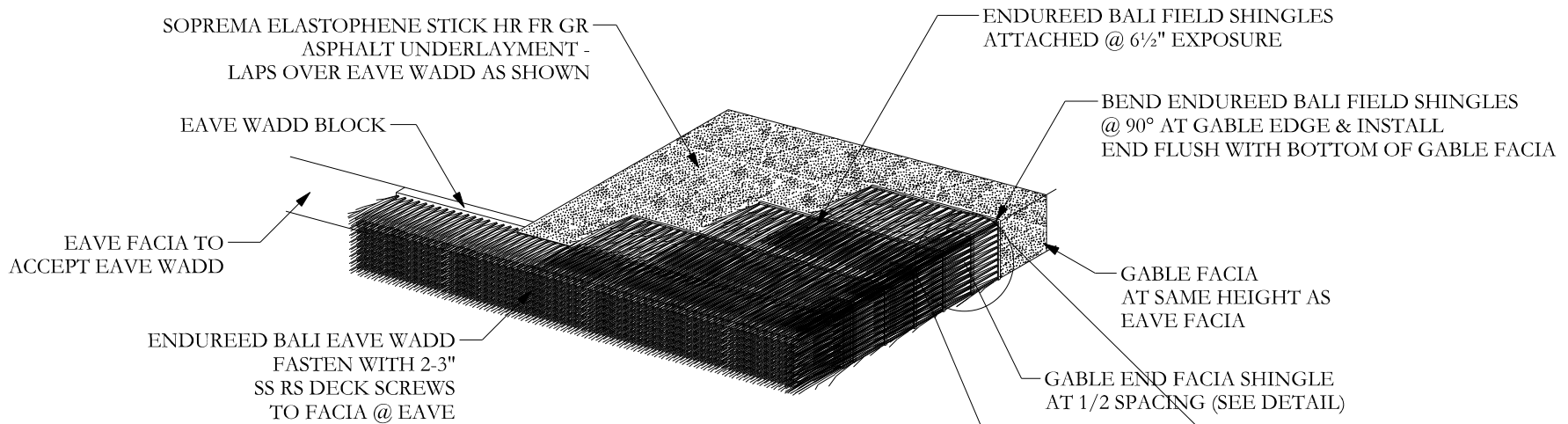

## TRIMMED EAVE GABLE DETAIL

SCALE: 1" = 1'-0"

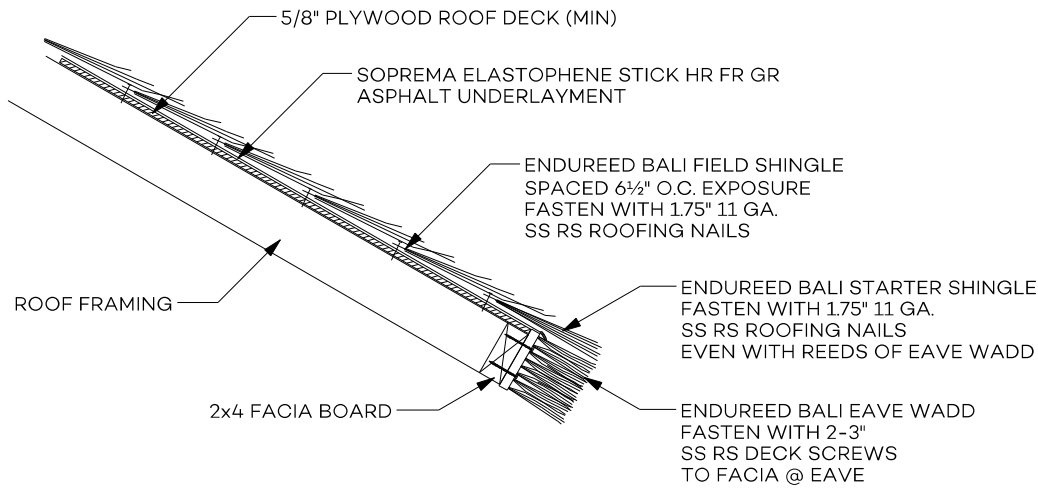

## TRIMMED EAVE SECTION

SCALE: 1" = 1'-0"

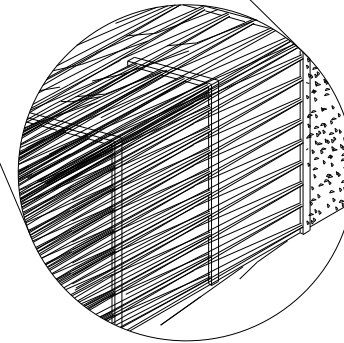

## GABLE END FACIA DETAIL

SCALE: N.T.S.

Global Innovation  
 313 SW Windswept Glen  
 Lake City, FL 32024  
 1-877-784-2824 | [endureed.com](http://endureed.com)





# Bali Island Eave Hip Detail

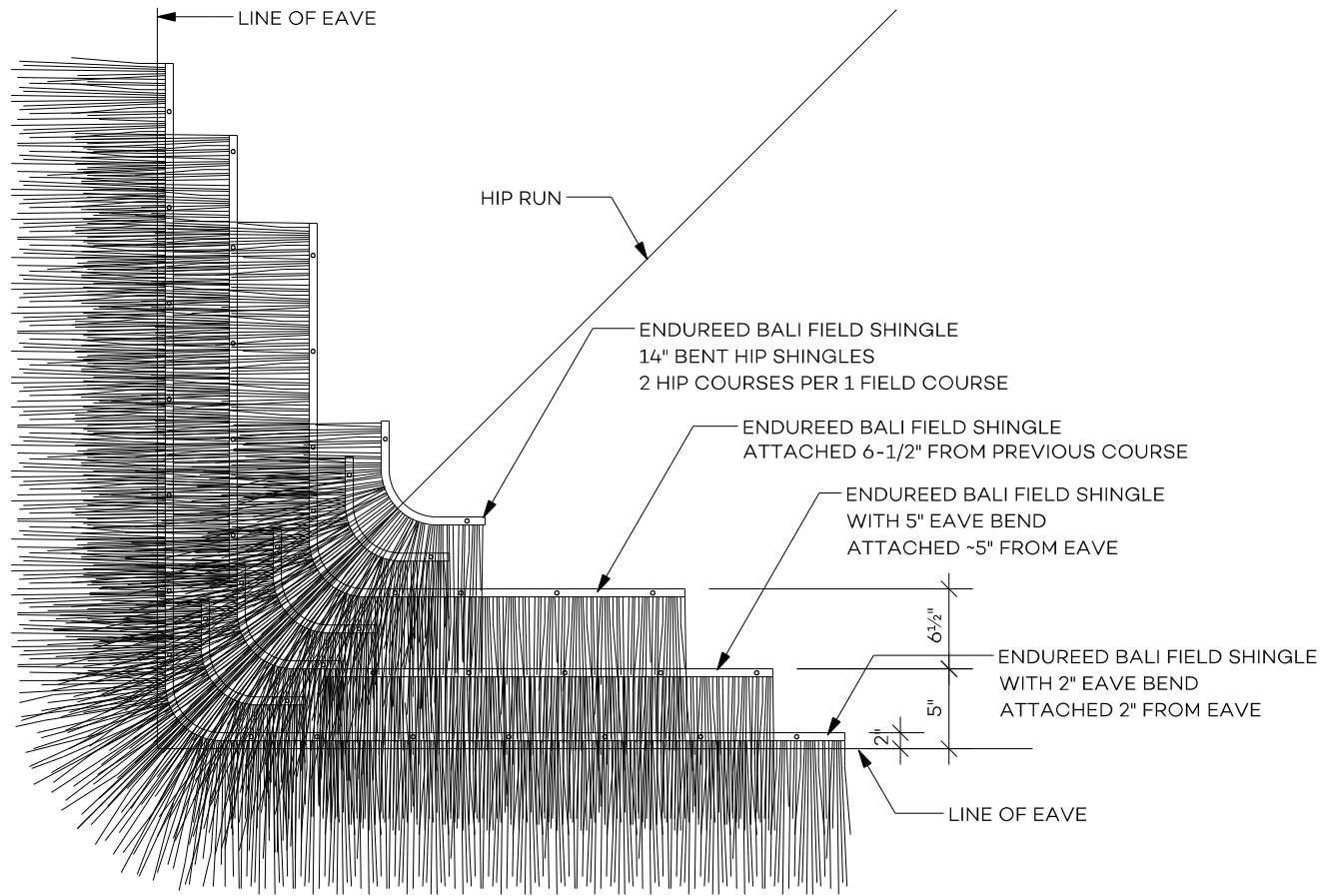

**HIP ATTACHMENT DETAIL**

SCALE: 1" = 1'-0"

Global Innovation  
 313 SW Windswept Glen  
 Lake City, FL 32024  
 1-877-784-2824 | [endureed.com](http://endureed.com)





# Bali Island Eave Detail

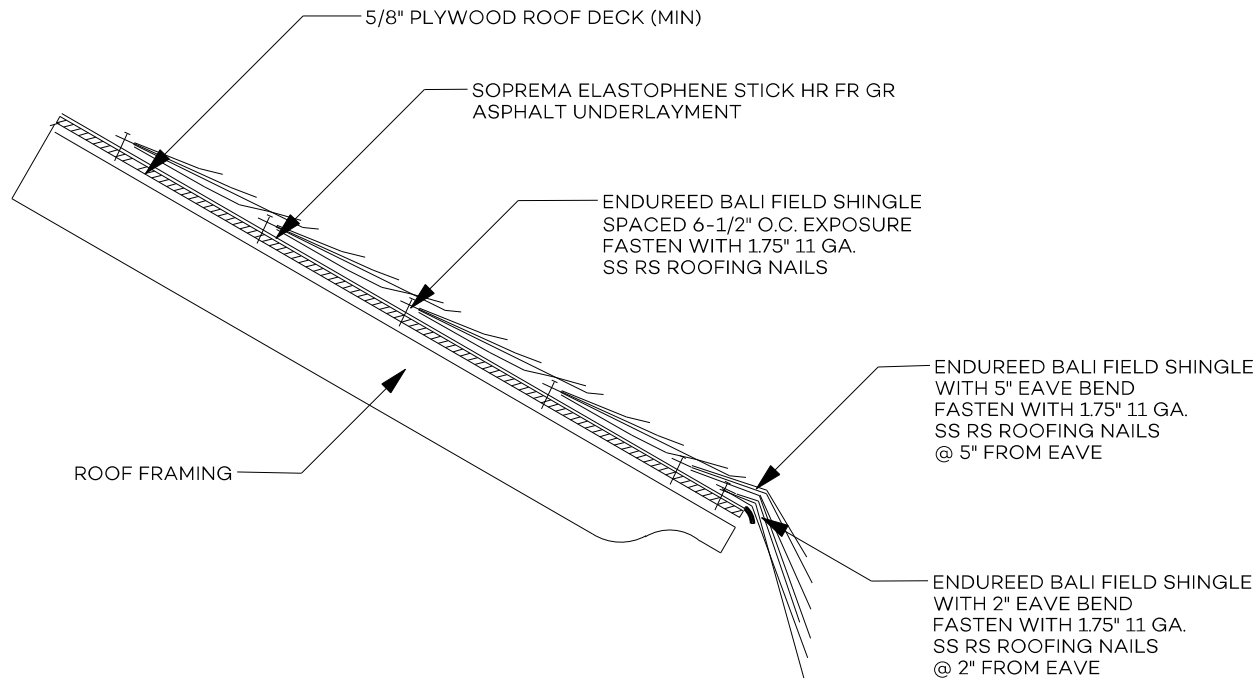

## ISLAND EAVE SECTION

SCALE: 1 1/2" = 1'-0"

Global Innovation  
 313 SW Windswept Glen  
 Lake City, FL 32024  
 1-877-784-2824 | [endureed.com](http://endureed.com)

